



Hose assembly

Handling guide

Special care for installation of hose assemblies.

Incorrect

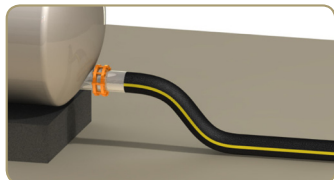

Never use hose unsupported

Correct

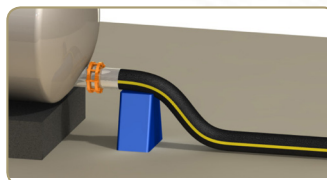

Always support hose near coupling

Incorrect

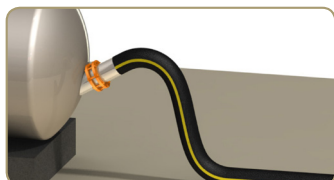

Correct

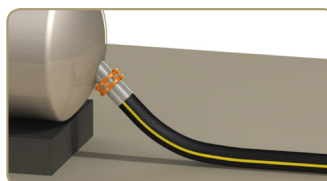

Incorrect

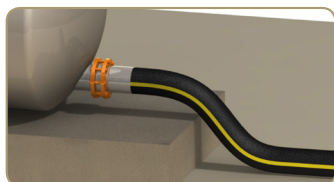

Protect against sharp edges, quay edges. Ship's guard rail etc.

Correct

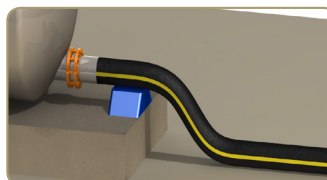

Acceptable

Incorrect

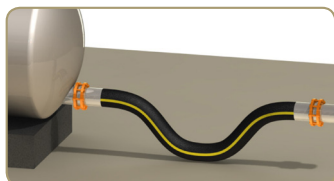

Never use hose unsupported

Correct

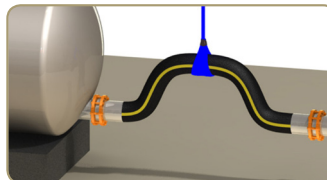

Support hose with slings where appropriate

Incorrect

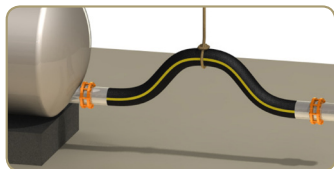

Never support hose with single rope

Incorrect

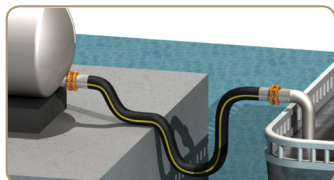

Never overbend hose or allow hose to hang between quay and ship

Correct

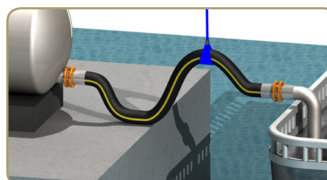

Support hose with slings



Hose assembly

Handling guide

Special care for installation of hose assemblies.

Incorrect



Correct



Incorrect



Correct



Incorrect



Correct



Incorrect



Correct





Hose assembly

Handling guide

Special care for installation of hose assemblies.

Incorrect



Correct



Incorrect



Correct



Incorrect

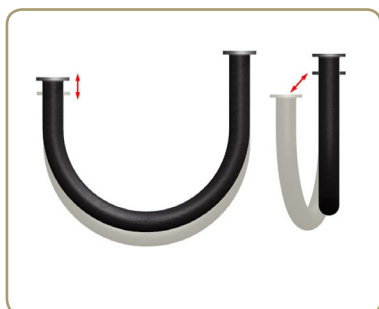

Correct

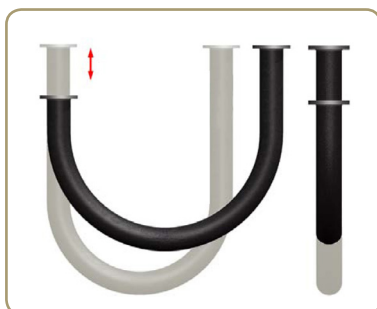

Incorrect

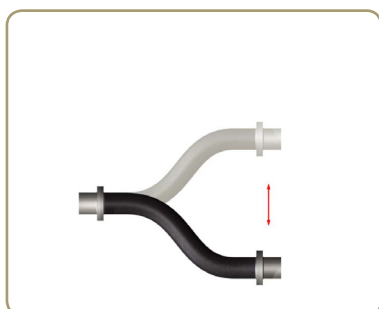

Correct





Hose assembly

Handling guide

Special care for installation of hose assemblies (diameter above 100 mm).

Incorrect

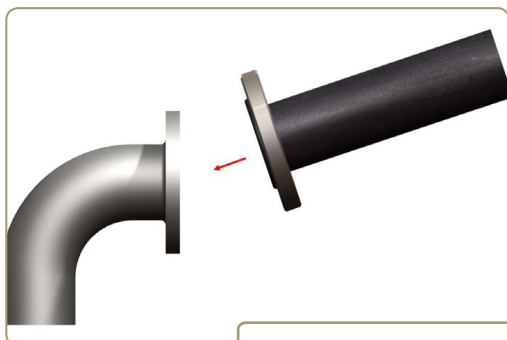

Correct

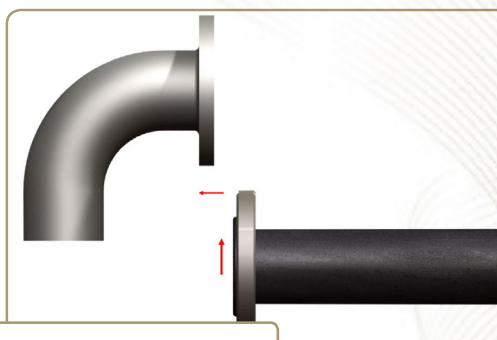

Always position the flange with hose straight

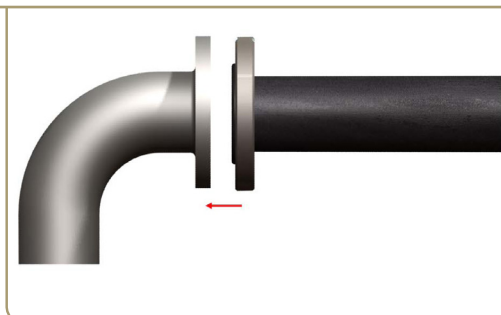

Special care for END-FLEX ends.

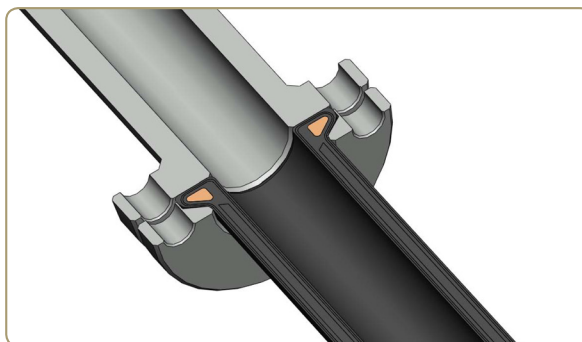

CORRECT on flat-face flanges

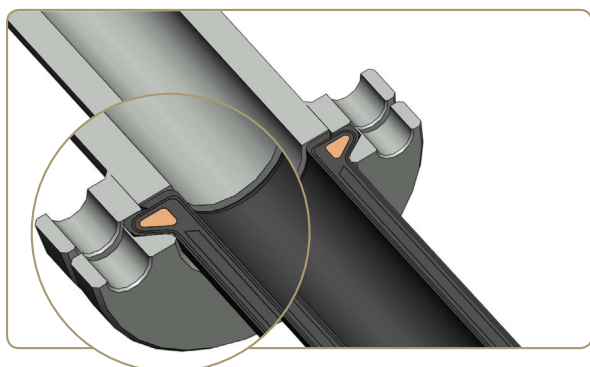

INCORRECT on raised-face flanges

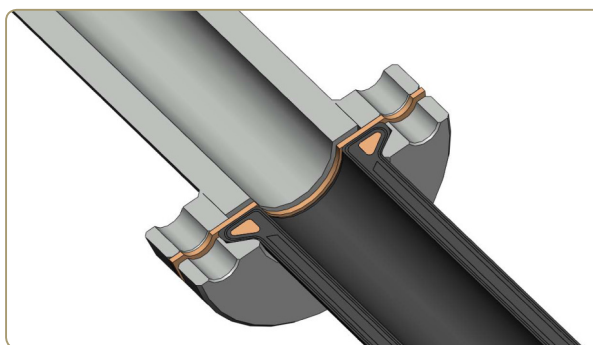

CORRECT on raised-face flanges with carbon fibre gasket



Hose assembly

Handling guide

Special care for installation of hose assemblies (diameter above 100 mm).

Incorrect



Correct



Incorrect



Correct



For transportation, installations or support in place,
never use a single rope to lift hose.
Only slings in sufficient numbers depending of the hose lengths.

For handling in straight length, a lifting beam must be used imperatively.

We recommend the use of slings (150 mm wide minimum).

Number of slings should be at least:

- 2 for length < 6 m
- 3 for length of 6 to 8 m
- 4 for length > 8 m

Correct

